



# Straight Abutments, Snap-on Transfers and Lab Analogs

## Straight Abutments

Includes Transfer, Comfort Cap & Fixation Screw with Dual-Grip™

Code	Platform	Collar Heights	Use Analog	Replacement Screw	Price
6035-21	3.5mmD	1mm	3037	1000-23	\$85.00
6035-22	3.5mmD	2mm	3037	1000-23	\$85.00
6035-23	3.5mmD	3mm	3037	1000-23	\$85.00
6043-21	4.3mmD	1mm	3047	1000-22	\$85.00
6043-22	4.3mmD	2mm	3047	1000-22	\$85.00
6043-23	4.3mmD	3mm	3047	1000-22	\$85.00
6050-21	5.0mmD	1mm	3057	1000-22	\$85.00
6050-22	5.0mmD	2mm	3057	1000-22	\$85.00
6050-23	5.0mmD	3mm	3057	1000-22	\$85.00
6060-21	6.0mmD	1mm	3065	1000-22	\$85.00
6060-22	6.0mmD	2mm	3065	1000-22	\$85.00
6060-23	6.0mmD	3mm	3065	1000-22	\$85.00



## Straight Abutment Transfers

Code	Abutment Width	Price (includes two pieces)
3037-02	3.7mmD	\$30.00
3047-02	4.7mmD	\$30.00
3057-02	5.7mmD	\$30.00
3065-02	6.5mmD	\$30.00



## Straight Abutment Comfort Caps

Code	Abutment Width	Price (includes two pieces)
3037-26	3.7mmD	\$30.00
3047-26	4.7mmD	\$30.00
3057-26	5.7mmD	\$30.00
3065-26	6.5mmD	\$30.00



## Straight Abutment Analogs

Includes Castable Coping

Code	Abutment Width	Price
3037	3.7mmD	\$35.00
3047	4.7mmD	\$35.00
3057	5.7mmD	\$35.00
3065	6.5mmD	\$35.00



## Straight Abutment Castable Copings

Code	Abutment Width	Price (includes two pieces)
3037-28	3.7mmD	\$30.00
3047-28	4.7mmD	\$30.00
3057-28	5.7mmD	\$30.00
3065-28	6.5mmD	\$30.00





# Selection Chart: Abutments for Partially Edentulous Restorations

## 3.5mmD Platform



## 4.3mmD Platform

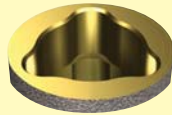

## 5.0mmD Platform

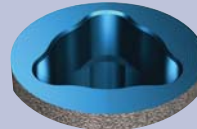

## 6.0mmD Platform

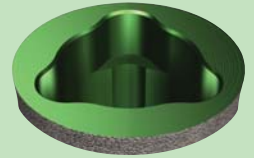

### Straight Abutments - Includes Transfer and Comfort Cap



6035-21 6035-22 6035-23



6043-21 6043-22 6043-23

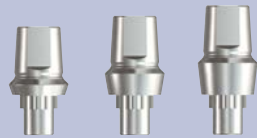

6050-21 6050-22 6050-23



6060-21 6060-22 6060-23

### Straight Contoured and Preparable Abutments



6035-31C 6035-31 6035-30L  
6035-32C

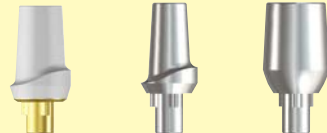

6043-31C 6043-31 6043-30L  
6043-32C



6050-31C 6050-31 6050-30L  
6050-32C

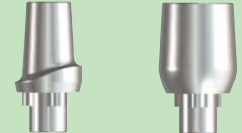

6060-31 6060-32  
6060-30L

### Angled Contoured Abutments



6035-51 6035-51-15C 6035-51-08C  
6035-52 6035-52-15C 6035-52-08C



6043-51 6043-51-15C 6043-51-08C  
6043-52 6043-52-15C 6043-52-08C



6050-51 6050-51-15C 6050-51-08C  
6050-52 6050-52-15C 6050-52-08C



6060-51  
6060-52

### Straight Contoured Abutments: Tri-Lobe at 30/60/90 Degrees

30/60/90 Degrees

6035-32-30  
6035-32-60  
6035-32-90



30/60/90 Degrees

6043-32-30  
6043-32-60  
6043-32-90



30/60/90 Degrees

6050-32-30  
6050-32-60  
6050-32-90



30/60/90 Degrees

6060-32-30  
6060-32-60  
6060-32-90



### Angled Contoured Abutments: Tri-Lobe at 30/60/90 Degrees

30/60/90 Degrees

6035-52-30  
6035-52-60  
6035-52-90



30/60/90 Degrees

6043-52-30  
6043-52-60  
6043-52-90



30/60/90 Degrees

6050-52-30  
6050-52-60  
6050-52-90



### Engaging and Non-Engaging Abutments



6035-40 6035-41 6035-46 6035-47 6035-49



6043-40 6043-41 6043-46 6043-47 6043-49



6050-40 6050-41 6050-46 6050-47 6050-49



6060-46 6060-47 6060-49

†non-engaging